



## Tecle Polipasto Prowinch c/carro electrico Monoviga 5 Tons trifasico

### Características Esenciales

- Equipo de Doble Velocidad, Mono viga. Servicio Heavy Duty H4/M5.
- Dispositivos de Límite de alta precisión, Protección de Sobrecarga y Protección térmica
- Componentes de alta calidad, Motor SEW Eurodrive, VDF Schneider, contactores Eaton/Schneider
- Estándares US y EC ASME HST-1 , ASME B30.16 , ASME B30.17 , EN14492-2 , EN60204-32.
- 3 Años de Garantía, Servicio y Atención al Cliente en Mexico

### Especificaciones Técnicas

<b>Capacidad de Carga</b>	11023 lb / 5000 kg	<b>Altura de Izaje Estandar (Customizable)</b>	Standard: 9 m / 30 ft (Customizable)
<b>Velocidad /min</b>	2.62 - 16.4 ft/min / 0.8 - 5 m /min	<b>Numero de Velocidades</b>	2 Speed
<b>Voltaje</b>	3 Phase 208~240/480V 50/60Hz	<b>Clase de Servicio</b>	H4/M5/2m/Class D
<b>Tipo de Motor</b>	Squirrel Cage Induction Motor	<b>Freno Motor</b>	Electromagnetic Release Brake >125%
<b>Grado de Aislacion</b>	F	<b>Protección IEC Motor</b>	IP55
<b>Protección Tablero de Control</b>	IP65	<b>Control</b>	Pendant Control and Optional Wireless F21
<b>Voltaje del Control</b>	48V	<b>Marca Motor de Izaje</b>	Sew Eurodrive
<b>Reductor de Izaje</b>	Sew Eurodrive FA	<b>Tipo Transmisión / Reductor</b>	Sew Eurodrive
<b>Humedad</b>	<85%	<b>Temperatura</b>	-4°~104° F / -20°~40° C
<b>Potencia del Trolley</b>	0.37 ~ 0.64 kW	<b>Nivel de Ruido</b>	82 dB
<b>Velocidad del Trolley /min</b>	16 ~ 65 ft/min. / 5 ~ 20 m/min	<b>Rango de ancho de la Viga</b>	7.9~13.7 in / 200~350 mm
<b>Normas</b>	ASME HST-4 , ASME B30.16 , B30.17 , EN14492-2 , EN60204-32	<b>Garantía</b>	3 Year
<b>Hoist Contactor Brand</b>	Schneider or EATON		

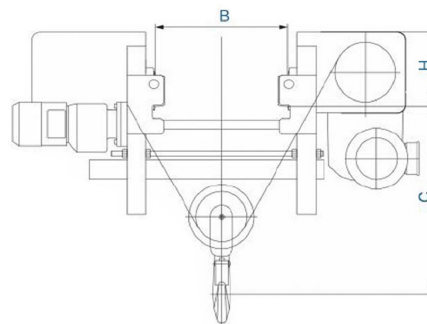
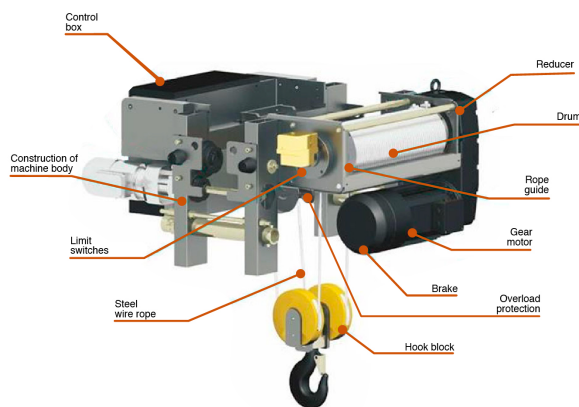

**DRIVE TECHNOLOGY**  
SEW Eurodrive high performance Motor, reducer and brake. Compact design, light weight, low energy consumption, low noise and eco-friendly design. Electromagnetic brake disc (Asbestos-free). Long Service life and easy maintenance.



**OVERLOAD PROTECTION**  
Load Cell connected to a Limit Relay (Adjustable) to avoid overloading of the hoist.



**WIRE ROPE GUIDE**  
Helps the winding of the rope on the drum. Light weight and highly resistance. Design to reduce friction on the wire rope and avoid premature wear.

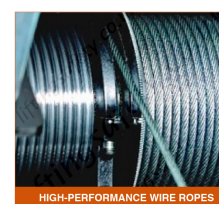

**HIGH-PERFORMANCE WIRE ROPES**  
High-performance wire rope with tensile strength up to 2160Mpa. Galvanized surface and high flexibility to ensure long service life.



**DRUM**  
Q345 steel, seamless grooved drum. Design to fulfill FEM and ASME standards and ensure a safe operation.



**LIMIT SWITCHES**  
High precision adjustable height limit switches, for all movements of hoist and trolley.

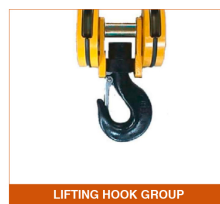

**LIFTING HOOK GROUP**  
DIN standard lifting hook with safety clasp. Forged by the high-strength material of T grade.



**CONTROL BOX**  
Electric Control box with Schneider Inverter, Eaton contactors and components. Compact design, easy access, IP65 Enclosure.

## Peso & Dimensiones

**Peso Total** 1323 lbs / 601 Kg

## Detalles del Empaque

**H Altura Muerta** 23.46

**A Altura Total** 33.31

Referential Images / Imágenes Referenciales  
Specifications may change without notice / las especificaciones pueden cambiar sin previo aviso